

## Company Profile



(SINCE 2005)

We are one of the leading manufacturer in the field of flow metering system, steam piping, PRDS, Flanges, Fittings. We also undertake site piping work & Boiler Repairing work. We have Well equipped workshop of 6,000 sq.ft. at Talawade, Pune, Maharashtra. We always strive to meet the exact standards of quality for our products. We supply better quality and better value for money to our customers using best quality control, suitable machinery, technology, trained manpower coupled with cost effectiveness that will sustain our future growth. We aim to be a Potential Manufacturer in the project industries for our product range.

### Our Expertise in the Field of

- Refineries & Petrochemicals
- Oil & Gas
- Chemicals & Fertilisers
- Cement
- Engineering
- Sugar Industry
- Paper & Pulp
- Pharmaceutical
- Distillery
- Rubber Industry
- Steel Plants
- Co-Generation Plants

### We Work With



## Product Range (IBR / NON IBR)

### FLANGES (Forged & Plate Type)

<b>Standards</b>	: B 16.36, B 16.5, B 16.47, BS 10, DIN
<b>Types</b>	: Orifice / Pipe Flanges (Plate & Forged) (Weldneck, Slipon, Blind, Socket Weld, RTJ Flange)
<b>Size</b>	: ½" NB To 48" NB
<b>Class</b>	: 150#, 300# , 600#, 900#, 1500# & 2500#.
<b>Material</b>	: Carbon Steel / Alloy Steel / Stainless Steel



### B.W. Fittings - Elbows, Tees, Reducers and Caps (Butt Welded)

<b>Sizes</b>	: 1/2" to 24"
<b>Types</b>	: Elbow/TEE/Concentric Reducer/Eccentric Reducer
<b>MOC</b>	: 234 WPB / 234 WP11 / 234 P22



### Forged Steel Fittings (Socket Weld/Threaded)

<b>Sizes</b>	: 1/2" to 2"
<b>Types</b>	: Elbow/TEE/Couplings / NIPPLE
<b>MOC</b>	: A105 / A182 F11 / A182 F22



### CONDENSING POT

<b>Types</b>	: Cap End / Flat End
<b>Size</b>	: 2", 3" & 4" NB
<b>Material</b>	: Carbon Steel / Alloy Steel / Stainless Steel



## Product Range (IBR / NON IBR)

### SYPHON

<b>Types</b>	: Pig Tail / U Type
<b>Size</b>	: 3/8" & 1/2" NB
<b>Material</b>	: Carbon Steel / Alloy Steel / Stainless Steel



### MANIFOLD

<b>Types</b>	: Flat / T-Type / H-Type
<b>Size</b>	: 2 Way / 3Way / 5 Way
<b>Material</b>	: Carbon Steel and Stainless Steel

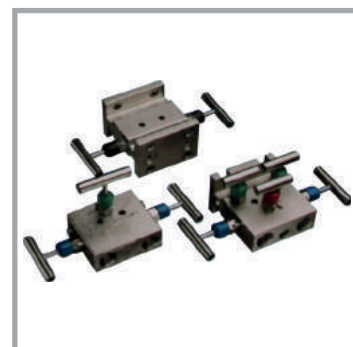

### ORIFICE PLATE

An Orifice plate is a most popular flow element. Orifice plates are precisely manufactured from the finest material with close tolerance to match ISO 5167 , BS 1042 and API 2530 & AGA report 3. Mountings between flanges or carrier ring (s) are available.

<b>Line size</b>	: 15 - 1500 mm (½" - 60" NB)
<b>Type</b>	: Concentric square edge, Quarter of circle , Conical entrance, Segmental, Eccentric
<b>Accuracy</b>	: ± 1%
<b>Materials</b>	: AISI 316, AISI 304



### ORIFICE PLATE ASSEMBLY

An Orifice plate assembly provides maximum economy with minimum maintenance. It consists of orifice plate , studs , nuts , jack bolts & gaskets. Flanges are according to ANSI , DIN, JIS standards. Type of orifice flanges includes Welds neck , Slip on, RTJ and T & G.

<b>Line size</b>	: 15-1500mm (½"-60" NB)
<b>Pressure tap</b>	: Flange tap , Corner tap , Radius tap (D & D/2 TAP)
<b>Accuracy</b>	: ±1 %
<b>Material of Flange</b>	: A105, A182 - F316, A182 - F304 , A182 - F11, A182 - F22

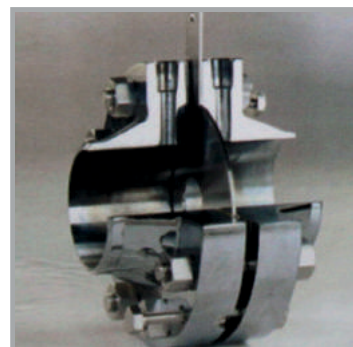

## Product Range (IBR / NON IBR)

### FLOW NOZZLE

A nozzle is a curved convergent entry leading to a short cylindrical throat without a discharge cone. It is generally selected for steam (vapour) flows at high velocities of flowing fluid. It is more stable at higher temperature & velocities than orifice, as it is rigid. The types are made according to the entrance.

<b>Line Size:</b>	Long radius nozzle - 50 - 630mm (2" - 24" NB) ISA 1932 - 50 - 500mm (2" - 20" NB)
<b>Types:</b>	Long radius nozzle, ISA 1932
<b>Pressure Tap:</b>	Long radius nozzle - Radius tap (D & D/2 tap) only, ISA 1932 - Corner tap only
<b>Accuracy:</b>	± 1%
<b>Material:</b>	AISI 316

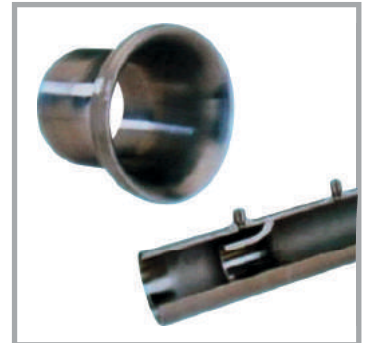

We also manufacture Flow Metering System, 2 Valve, 3 Valve, 5 Valve Manifold, Isolation Valve, Condensing Pot, Air Header and Syphon.

### VENTURI TUBE

A Venturi tube has a conical convergent entry followed by a cylindrical throat & a conical divergent outlet. Manufactured to ISO 5167, BS 1042 standards, it substantially reduces permanent pressure loss. The types are made according to the manufacturing methods of the internal surface of the entrance cone & profile at the intersection of the entrance cone & throat.

<b>Line size</b>	: Type A - 100 - 800mm (4" - 32" NB) Type B - 50 - 250mm (2" - 10" NB) Type C - 200 - 1200mm (8" - 48" NB)
<b>Type</b>	: Type A - Cast Convergent section, Type B - Machined convergent section, Type C - Rough Welded sheet - iron convergent section.
<b>Accuracy</b>	: Type A - ±0.7%, Type B - ± 1.0 % Type C - ± 1.5%



### Pressure Reducing & Desuper Heating System (PRDS)

PROS is used to reduce the pressure of steam as well as temperature. PRDS is used for Bypass for turbine & L.P steam to Process.

<b>Line size</b>	: 15 - 1200 mm (½" - 48" NB)
<b>Accuracy</b>	: Pneumatic control ±1% Electronic Control ±0.5%
<b>Material</b>	: Carbon Steel / Alloy Steel
<b>Make of Valve</b>	: Pnecon / Forbes Arca / RK / Equivalent



### Steam Header & Piping

We Manufacture Steam Header & Piping on turnkey basis. At our works as well as on site all over India. We have 1st class as well as special class Licence under IBR 1950

<b>Line size</b>	: 15 - 200 mm (½" - 48" NB)
<b>Material</b>	: Carbon Steel / Alloy Steel / Stainless Steel
<b>Category</b>	: With Material basis as well as Labour basis



We undertake Turnkey Project in Piping on Site with IBR Approved )



## FORGED STEEL GATE VALVES AND GLOBE VALVES

### FORGED CARBON STEEL GATE VALVE ASA 800 CLASS OUTSIDE SCREW & YOKE TYPE BOLTED BONNET

<b>BODY / BONNET</b>	: ASTM A 105
<b>TRIMS</b>	: 13 Cr
<b>MFG STD</b>	: API 602 / BS 5352
<b>INSP &amp; TEST STD</b>	: API 598 / BS 6755
<b>ENDS</b>	: SCREWED TO BSP / BSPT / NPT SOCKETWELD TO ANSI B 16.11
<b>HYD-TEST PRESSURE</b>	: BODY : 3000 Psig (211 Kg/Cm <sup>2</sup> ) SEAT : 2000 Psig (140 Kg/Cm <sup>2</sup> )
<b>SIZE RANGE</b>	: 15 MM TO 50 MM



### FORGED CARBON STEEL GATE VALVE ASA 1500 / 2500 CLASS OUTSIDE SCREW & YOKE TYPE BOLTED BONNET

<b>BODY / BONNET</b>	: ASTM A 105
<b>TRIMS</b>	: 13 Cr
<b>MFG STD</b>	: API 602 j BS 5352
<b>INSP &amp; TEST STD</b>	: API 598 j BS 6755
<b>ENDS</b>	: SCREWED TO BSPT j NPT SOCKETWELD TO ANSI B 16.11
<b>HYD-TEST PRESSURE</b>	: BODY : 5400 Psig (379 Kg/Cm <sup>2</sup> ) FOR 1500# SEAT : 4000 Psig (281 Kg/Cm <sup>2</sup> ) FOR 1500# BODY : 9000 Psig (633 Kg/Cm <sup>2</sup> ) FOR 2500# SEAT : 6600 Psig (464 Kg/Cm <sup>2</sup> ) FOR 2500#
<b>SIZE RANGE</b>	: 15 MM TO 40 MM



### FORGED CARBON STEEL GATE VALVE ASA 150 / 300 CLASS OUTSIDE SCREW & YOKE TYPE BOLTED BONNET

<b>BODY / BONNET</b>	: ASTM A 105
<b>TRIMS</b>	: 13 Cr
<b>MFG STD</b>	: API 6021BS 5352
<b>INSP &amp; TEST STD</b>	: API 598 1BS 6755
<b>ENDS</b>	: FLANGED TO ANSI B 16.5 RF (150#/300#)
<b>HYD-TEST PRESSURE</b>	: BODY: 425 Psig (30 Kg/Cm <sup>2</sup> ) FOR 150# SEAT : 300 Psig (21 Kg/Cm <sup>2</sup> ) FOR 150# BODY : 1100 Psig (77 Kg/Cm <sup>2</sup> ) FOR 300# SEAT : 800 Psig (56 Kg/Cm <sup>2</sup> ) FOR 300#
<b>SIZE RANGE</b>	: 15 MM TO 50 MM



## ISO 9001 : 2015 CERTIFICATE

 **महाराष्ट्र शासन**  
कार्यवाह विभाग  
वाष्पके संचालनालय

कमंक: २५५१२५१/१३५४/१३५४ कार्यालय, १३५४/१३५४, प्लॉट नं. २०, बॉम्बे, ई.  
२५५१२५१२५१ कार्यालय, १३५४/१३५४, प्लॉट नं. २०, बॉम्बे, ई.  
E-mail: dirsb.mumbai@maharashtra.gov.in, https://mahakangar.maharashtra.gov.in, http://www.mahaboller.in

कमंक: २५५१२५१/१३५४/१३५४/२५०२ दिनांक: २२ FEB २०२२

प्रति,  
मे. संकल्प इंजीनियर्स,  
आर. नं. ६५, प्लॉट नं. २,  
तलवाडे, पुणे, ४११००२.

विषय :- "फॉर्ज्ड प्लेट (Forged & Plate) (Size upto 20") व फिटींग (Forged & Seamless) (Machining Only) (Size upto 12") जे निमित्त मल्लम विलेखन मायतरेचे मुतनीकरण करण्यात आले.

संदर्भ :- या कार्यालयाचे पत्र कमंक: SB-5/SRW/2020/4078, दिनांक ०६.०३.२०२०

महोदय,  
आपले पत्र कमंक: NIL, दिनांक १६.१२.२०२१, या संदर्भात आपणास कळविण्यात येते की, या कार्यालयाचे उपरोक्त संदर्भित पत्राद्वारे आपणास या विभागामध्ये परीक्षेद्वाराखाली भारतीय वाष्पक विनियम, १९२० नुसार "फॉर्ज्ड प्लेट (Forged & Plate) (Size upto 20") व फिटींग (Forged & Seamless) (Machining Only) (Size upto 12") ची निमित्त मल्लम विलेखन मायतरेचे मुतनीकरण करण्यात आले. ती आपा उपरोक्त नमुद कोळ्या या कार्यालयाच्या पत्रातील अटीवरच, दिनांक ३१ डिसेंबर २०२२ पर्यंत वाढविण्यात येत आहे.

तसेच आपणास कळविण्यात येते की, पुढील मुतनीकरणाबाबतचा अर्ज, वरील मुदत समाप्तीच्या किमान ३० दिवस अगोदर सादर करावा.

आपला दिवसगुरू,  
(स.प्र.अंतर्पुरकार)  
संचालक,  
वाष्पके, महाराष्ट्र राज्य, मुंबई.

प्रत :- सहसंचालक, वाष्पके, महाराष्ट्र राज्य, पुणे/मंगलूर/अहमदनगर/नाशिक/कोलहापुर/सोलापुर

## IBR APPROVAL

 **महाराष्ट्र शासन**  
कार्यवाह विभाग  
वाष्पके संचालनालय

कमंक: २५५१२५१/१३५४/१३५४ कार्यालय, १३५४/१३५४, प्लॉट नं. २०, बॉम्बे, ई.  
२५५१२५१२५१ कार्यालय, १३५४/१३५४, प्लॉट नं. २०, बॉम्बे, ई.  
E-mail: dirsb.mumbai@maharashtra.gov.in, https://mahakangar.maharashtra.gov.in, http://www.mahaboller.in

कमंक: २५५१२५१/१३५४/१३५४/२५०२ दिनांक: २२ FEB २०२२

प्रति,  
मे. संकल्प इंजीनियर्स,  
आर. नं. ६५, प्लॉट नं. २,  
तलवाडे, पुणे, ४११००२.

विषय :- "Flow Elements" (as Orifice Plate Assembly, Flow Nozzle, Venturi, MROFA, Meter Run Assembly, Condensing Post, Siphon Pipe Spools etc.) जे निमित्त मल्लम विलेखन मायतरेचे मुतनीकरण करण्यात आले.

संदर्भ :- या कार्यालयाचे पत्र कमंक: SB-5/SRW/2020/4078, दिनांक ०६.०३.२०२०

महोदय,  
आपले पत्र कमंक: NIL, दिनांक १६.१२.२०२१, या संदर्भात आपणास कळविण्यात येते की, या कार्यालयाचे उपरोक्त संदर्भित पत्राद्वारे आपणास या विभागामध्ये परीक्षेद्वाराखाली भारतीय वाष्पक विनियम, १९२० नुसार "Flow Elements" (as Orifice Plate Assembly, Flow Nozzle, Venturi, MROFA, Meter Run Assembly, Condensing Post, Siphon Pipe Spools etc.) ची निमित्त मल्लम विलेखन मायतरेचे मुतनीकरण करण्यात आले. ती आपा उपरोक्त नमुद कोळ्या या कार्यालयाच्या पत्रातील अटीवरच, दिनांक ३१ डिसेंबर २०२२ पर्यंत वाढविण्यात येत आहे.

तसेच आपणास कळविण्यात येते की, पुढील मुतनीकरणाबाबतचा अर्ज, वरील मुदत समाप्तीच्या किमान ३० दिवस अगोदर सादर करावा.

आपला दिवसगुरू,  
(स.प्र.अंतर्पुरकार)  
संचालक,  
वाष्पके, महाराष्ट्र राज्य, मुंबई.

प्रत :- सहसंचालक, वाष्पके, महाराष्ट्र राज्य, पुणे/मंगलूर/अहमदनगर/नाशिक/कोलहापुर/सोलापुर

 **GOVERNMENT OF MAHARASHTRA**  
LABOUR DEPARTMENT  
DIRECTORATE OF STEAM BOILERS  
Kamgarbhavan 7<sup>th</sup> floor, Plot No. C-20,  
Block - E, Bandra-Kurla Complex, Bandra (E)  
Mumbai - 400 051

Phone No. 022 - 26571201/130411332  
Fax: 022 - 26571283  
E-mail: dirsb.mumbai@maharashtra.gov.in | www.mahakangar.maharashtra.gov.in | http://www.mahaboller.in

Reference No: SB-5/NSK/2021/1005440  
Dated: 26-04-2022

To,  
SANKALP ENGINEERS  
GAT NO 65 PLOT NO 2, DEHU ALANDI ROAD,  
BHARAT WEIGH BRIDGE, TALWADE,  
TALWADE, HAVELI, PUNE 412114

Sub: - Renewal of approval as a "Pipe Fabricator, Class 1" as per Indian Boiler Regulations, 1950 and its latest amendments.  
Ref: - Your online application vide ID: 100000942275 dt.23-03-2022

Gentlemen,  
With reference to your online application vide 100000942275, dated 23-03-2022, on above subject, I have to inform you that your approval as "Pipe Fabricator, Class 1" as per Indian Boiler Regulation 1950 and its latest amendments is renewed upto to 31<sup>st</sup> December 2023, subject to conditions laid down in letter of approval.  
You are informed to submit your next application for renewal at least Two month before the expiry date.

Digitally Signed by (Dhawal Prakash Antapurkar)  
(Government of Maharashtra)  
Date: 26-Apr-2022 11:52:51 IST

Yours faithfully,  
(Dhawal Prakash Antapurkar)  
Director of Steam Boilers,  
Maharashtra State, Mumbai

 **महाराष्ट्र शासन**  
कार्यवाह विभाग  
वाष्पके संचालनालय

कमंक: २५५१२५१/१३५४/१३५४ कार्यालय, १३५४/१३५४, प्लॉट नं. २०, बॉम्बे, ई.  
२५५१२५१२५१ कार्यालय, १३५४/१३५४, प्लॉट नं. २०, बॉम्बे, ई.  
E-mail: dirsb.mumbai@maharashtra.gov.in, https://mahakangar.maharashtra.gov.in, http://www.mahaboller.in

कमंक: २५५१२५१/१३५४/१३५४/२५०२ दिनांक: २२ FEB २०२२

प्रति,  
मे. संकल्प इंजीनियर्स,  
आर. नं. ६५, प्लॉट नं. २,  
तलवाडे, पुणे, ४११००२.

विषय :- "फॉर्ज्ड प्लेट (Forged & Plate) (Size upto 10") व फिटींग (Forged & Seamless) (Machining Only) (Size upto 12") जे निमित्त मल्लम विलेखन मायतरेचे मुतनीकरण करण्यात आले.

संदर्भ :- या कार्यालयाचे पत्र कमंक: SB-5/SRW/2020/4078, दिनांक ०६.०३.२०२०

महोदय,  
आपले पत्र कमंक: NIL, दिनांक १६.१२.२०२१, या संदर्भात आपणास कळविण्यात येते की, या कार्यालयाचे उपरोक्त संदर्भित पत्राद्वारे आपणास या विभागामध्ये परीक्षेद्वाराखाली भारतीय वाष्पक विनियम, १९२० नुसार "फॉर्ज्ड प्लेट (Forged & Plate) (Size upto 10") व फिटींग (Forged & Seamless) (Machining Only) (Size upto 12") ची निमित्त मल्लम विलेखन मायतरेचे मुतनीकरण करण्यात आले. ती आपा उपरोक्त नमुद कोळ्या या कार्यालयाच्या पत्रातील अटीवरच, दिनांक ३१ डिसेंबर २०२२ पर्यंत वाढविण्यात येत आहे.

तसेच आपणास कळविण्यात येते की, पुढील मुतनीकरणाबाबतचा अर्ज, वरील मुदत समाप्तीच्या किमान ३० दिवस अगोदर सादर करावा.

आपला दिवसगुरू,  
(स.प्र.अंतर्पुरकार)  
संचालक,  
वाष्पके, महाराष्ट्र राज्य, मुंबई.

प्रत :- सहसंचालक, वाष्पके, महाराष्ट्र राज्य, पुणे/मंगलूर/अहमदनगर/नाशिक/कोलहापुर/सोलापुर

 **CERTIFICATE OF APPROVAL**  
Certificate No. 2017-HK-0150

**SANKALP ENGINEERS**  
Get No. 65, Plot No. 2, Shelar Wasti, Dehu-Alandi Road, Talawade, Pune - 411 062, Maharashtra, India

This is to certify that the Management System of the above organization has been found to conform to the requirements of the standard:

Standard: ISO 9001:2015  
Scopes of Registration: Design and Manufacture of Primary and Secondary Flow Elements, such as Orifice Assembly, Flow Nozzles, Venturi, Meter Run Assembly, Condensing Post, Siphon, Pressure Reducing Station (PRS), Flanges, Manifolds, Socket Weld and Butt Weld Fittings and Valves

Original Approval Date: 28<sup>th</sup> March, 2016  
Current Approval Date: 4<sup>th</sup> June, 2019  
Valid Upto: 27<sup>th</sup> March, 2020  
Certification Cycle Year: 2019-2022

This approval is valid only if the organization is found to be in compliance with the requirements of the standard as set out in the Certificate of Approval. The organization is required to maintain the standard and to provide evidence of compliance to the certification body.

Authorized Signatory: 

IRCAO  
International Register of Certificated Auditors  
Accreditation Body: Accreditation Service for Certificated Bodies (European Ltd.)  
Issuing Authority: BS Certification Services Limited  
Place: 60, The Square, 10, Long Street, London, EC1A 3BB, UK

# Multiport Averaging Pitot Tube

## DESCRIPTION

The Multiport Averaging Pitot Tube is a differential pressure device suitable to measure the flow rate in a closed conduit for general applications (it is a general purpose and affordable device). Normally used in big pipes with low flow velocity.



## TECHNICAL SPECIFICATIONS

<b>Applications</b>	Oil & Gas / Petrochemical Industries / Power Stations
<b>Type Of Elements</b>	Standard Model ED-20/21: Diamond Shape-Manufactured by Square Bar 20x20 mm Standard Model ED-45/46: Diamond Shape-Manufactured by Square Bar 45x45 mm Special Device: Diamond Shape-Manufactured by Square Bar sized with Stress and Vibrations Analysis Results;
<b>Material</b>	As per Customer's requirements / Main material References: ASME/ASTM
<b>Process Connections</b>	Threaded Coupling / Flanged Nozzle
<b>Flow Calculation</b>	Main Reference code: AS PER STANDARDS

## PERFORMANCES

- Accuracy (referred to flow coefficient): 2 to 2.5% for Standard Device; to be evaluated case by case for Special Devices
- Repeatability: +/- 0.15%
- Max PPL 10±15% of full scale differential pressure

## CALIBRATION

- Not Applicable

## NOTE

- Flow Meters can be manufactured according to all Customer Specifications
- Flow Meter can be supplied complete with all relevant accessories (valves / manifold / condensing pot / transmitter / fitting / tubing)

# Metering Skid

## DESCRIPTION

A metering skid is a part of plant, pre-assembled on a steel support, dedicated to the measurement of gas or liquid products. In particular, the main variable to be measured is the flowrate. Depending on the selected technology and on the Client Specifications, the measured flowrate can be a mass flowrate or a volumetric flowrate. The metering skid often performs additional treatments, such as pressure-reduction by means of valves, filtration (depending on fluid cleanliness requirements for measurement), and flow control by means of flow control valves. Fiscal metering skids often include a calibration system (Prover) as well.



## THE METERING SKID MAIN COMPONENTS ARE

- The structural frame and supports
- The pipework
- The process equipment
- The electrical power feed, including the MCC, the earthing system, all cabling and trays
- The instrumentation including control valves, actuators, instrument primary elements, transmitters
- The local control system including PLC, flow computer, personal computer & printer (for the local control, print report and the interface with the plant DCS)



“SANKALP ENGINEERS” make Gate Valves are Primarily Designed to start or stop flow & when a straight line flow of fluid & minimum flow restriction are needed. in service this vavle generally are either fully open or fully closed.

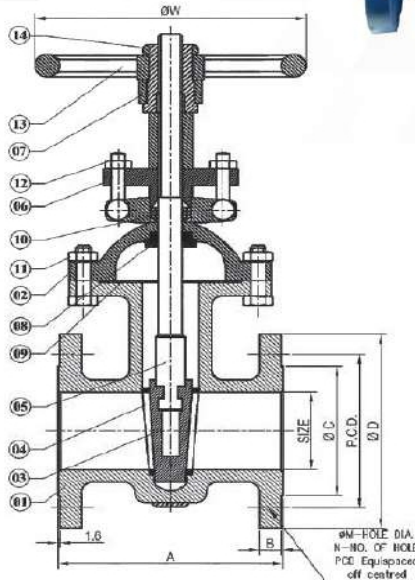

NO	DESCRIPTION	MATERIAL	QTY.
01.	BODY	ASTM A 216 Gr. WCB/CF8/CF8M	1
02.	BONNET	ASTM A 216 Gr. WCB/CF8/CF8M	1
03.	WEDGE	ASTM A 216 Gr. WCB/CF8/CF8M	1
04.	SEAT RING	AISI 410 (13% CR) / SS 304 / 316	2
05.	STEM	AISI 410 (13% CR) / SS 304 / 316	1
06.	GLAND	CARBON STEEL	1
07.	YOKE SLEEVE	NI - RESIST - NODULAR CAST IRON	1
08.	BACK SEAT	AISI 410 (13% CR) / SS 304 / 316	1
09.	GASKET	SPRAL WOUND METALIC	1
10.	GLAND PACKING	METALIC WIRE REINFORCE	—
		GRAPHOIL ASBESTOS	Req.
11.	BONNET STUB & NUT	ASTM A 193 Gr. B7 / ASTM A 194 Gr. 2H	Req.
12.	EYE BOLT & NUT	ASTM A 193 Gr. B7 / ASTM A 194 Gr. 2H	2SET
13.	HAND WHEEL	S G IRON	1
14.	HAND WHEEL NUT	CARBON STEEL	1

TECHNICAL DATA	
DESIGN & MANUFACTURING STD.	BS-1414 / AP / 600
TESTING & INSPECTION STD.	AP / 598
END CONNECTIONS :	FLANGED AS PER ANSI B-16.5
SEAL WALL THICKNESS	ANSI B 16.34
FACE TO FACE :	AS PER ANSI / B 16.10

PRIMARY SERVICE RATING & TEST PRESSURE				
CLASS	WORKING PRES.	TEMP.	HYD. TEST PRESS. BODY	SEAT
150	150 PSIG	500°F	425 PSIG	300 PSIG
300	300 PSIG	800°F	1100 PSIG	800 PSIG
AIR TEST - SEAT - 80 PSIG + 10 PSIG				

SIZE		CLASS - 150							
IN.	M.M.	A	B	ØC	ØD	ØM	N	P.C.D.	ØW
1"	25	127.0	11.0	51	108.0	16	4	79.2	100
1.1/2"	40	165.1	14.2	73	127.0	16	4	98.5	135
2"	50	177.8	15.7	92	152.0	19	4	120.6	200
2.1/2"	65	190.5	17.5	105	178.0	19	4	139.7	250
3"	80	203.2	19.0	127	190.5	19	4	152.4	250
4"	100	228.6	24.0	157	229.0	19	8	190.5	300
5"	125	254.0	24.0	186	254.0	22	8	215.9	350
6"	150	266.7	25.0	216	279.0	22	8	241.3	350
8"	200	292.1	28.5	270	343.0	22	8	298.4	400
10"	250	330.2	30.0	324	406.0	25	12	362.0	450
12"	300	335.6	32.0	381	483.0	25	12	431.8	500
14"	350	381.0	35.0	413	534.0	28	12	476.2	508
16"	400	406.4	36.5	470	597.0	28	16	539.0	508

SIZE		CLASS - 300							
IN.	M.M.	A	B	ØC	ØD	ØM	N	P.C.D.	ØW
1.1/2"	40	190.5	20.5	73	155.4	22	4	114.3	152
2"	50	215.9	22.0	92	166.0	19	8	127.0	203
2.1/2"	65	241.3	25.0	105	190.5	22	8	149.3	203
3"	80	282.5	28.5	127	209.5	22	8	168.1	254
4"	100	304.8	32.0	157	254.0	22	8	200.1	305
5"	125	381.0	35.0	186	279.4	22	8	234.9	356
6"	150	403.2	36.5	216	317.5	22	12	269.7	356
8"	200	419.1	41.0	270	381.0	25	12	330.2	407
10"	250	457.2	48.0	324	444.5	29	16	387.3	457
12"	300	501.6	51.0	381	520.7	32	16	450.8	508
14"	350	762.0	54.0	413	584.2	32	20	514.3	508
16"	400	838.2	57.0	470	647.7	35	20	571.5	508



“SANKALP ENGINEERS” make globe valves is linear motion valve and are primarily designed to stop, start and regulate flow. the disc of a globe valve can be totally removed from the flowpath or it can completely close flowpath

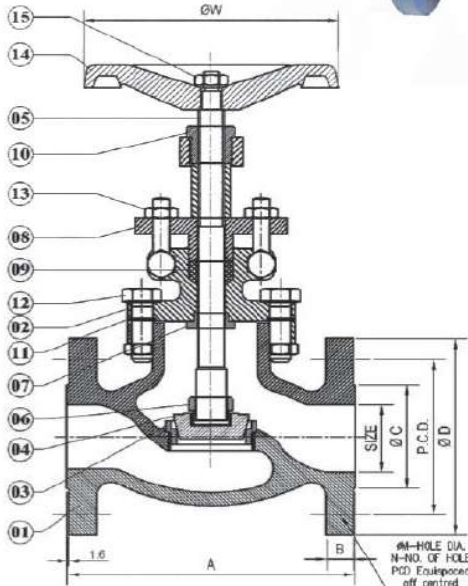

NO	DESCRIPTION	MATERIAL	QTY.
01	BODY	ASTM A216 Gr. WCB / CF8 / CF8M	1
02	BONNET	ASTM A216 Gr. WCB / CF8 / CF8M	1
03	SEAT RING	AISI410 (13% CR) SS 304 / 316	1
04	DISC	AISI410 (13% CR) SS 304 / 316	1
05	STEM	AISI410 (13% CR) SS 304 / 316	1
06	STEM NUT	AISI410 (13% CR) SS 304 / 316	1
07	BACK SEAT	AISI410 (13% CR) SS 304 / 316	1
08	GLAND	CARBON STEEL	1
09	GLAND PACKING	METALIC WIRE REINFORCED GRAPHOLASBESTOS	----
10	YOKE SLEEVE	SG IRON	1
11	BONNET GASKET	ASBESTOS FILTER S.S. 304 SPRIAL WOUNDED / CAF	1
12	BONNET STUD & NUT	ASTM A193 Gr. B7 ASTM A194 Gr. 2H	----
13	EYE BOLT & NUT	ASTM A193 Gr. B7 ASTM A194 Gr. 2H	2 SET
14	HAND WHEEL	SG IRON	1
15	HAND WHEEL NUT	CARBON STEEL	1

#### TECHNICAL DATA

DESIGN & MANUFACTURING STD.	BS 1873
TESTING & INSPECTION STD.	API 598 / BS 5146
END CONNECTIONS :	FLANGED AS PER ANSI B-16.5
SHELL WALL THICKNESS	AVSI B 16.34
FACE TO FACE :	AS PER ANSI / B 16.10

#### PRIMARY SERVICE RATING & TEST PRESSURE

CLASS	WORKING PRES.	TEMP.	HYD. TEST PRESS. BODY	SEAT
150	150 PSIG	500°F	425 PSIG	300 PSIG
300	300 PSIG	800°F	1100 PSIG	800 PSIG

SIZE		CLASS - 150							
IN.	M.M.	A	B	ØC	ØD	ØM	N	P.C.D.	ØW
1"	25	127	11.0	51	108.0	16	4	79.2	100
1.1/2"	40	165	14.2	73	127.0	16	4	98.5	135
2"	50	203	15.7	92	152.0	19	4	120.6	200
2.1/2"	65	216	17.5	105	178.0	19	4	139.7	250
3"	80	241	19.0	127	190.5	19	4	152.4	250
4"	100	292	24.0	157	229.0	19	8	190.5	300
5"	125	356	24.0	186	254.0	22	8	215.9	350
6"	150	406	25.0	216	279.0	22	8	241.3	350
8"	200	495	28.5	270	343.0	22	8	298.4	400
10"	250	622	30.0	324	406.0	25	12	362.0	450
12"	300	698	32.0	381	483.0	25	12	431.8	500

SIZE		CLASS - 300							
IN.	M.M.	A	B	ØC	ØD	ØM	N	P.C.D.	ØW
1"	25	203.0	17.5	51	124.0	19	4	89.0	135
1.1/2"	40	229.0	20.5	73	155.5	22	4	114.3	200
2"	50	267.0	22.0	92	165.0	19	8	127.0	200
2.1/2"	65	292.0	25.0	105	190.5	22	8	149.3	200
3"	80	317.5	28.5	127	209.5	22	8	168.0	300
4"	100	356.0	32.0	157	254.0	22	8	200.0	350
5"	125	400.0	35.0	186	279.4	22	8	235.0	350
6"	150	444.5	36.5	216	317.5	22	12	269.7	400
8"	200	559.0	41.0	270	381.0	25	12	330.2	550
10"	250	622.0	47.5	324	444.5	28	16	387.4	600
12"	300	711.0	51.0	381	521.0	32	16	450.8	600





(SINCE 2005)

# sankalp engineers

AN ISO9001 : 2015 APPROVED COMPANY  
IBR APPROVED COMPANY

## WORKS

### Sankalp Engineers

Gat No.65, Plot No.2, Shelar Wasti,  
Talawade, Pune - 411062 (Maharashtra)

☎ +91 7823064582

✉ [sankalp.engineers@rediffmail.com](mailto:sankalp.engineers@rediffmail.com)

🌐 [www.sankalpengineers.in](http://www.sankalpengineers.in)

